

NOTE: BREAK ALL CORNERS WITH 0.015" (.38 MM) RADIUS UNLESS OTHERWISE NOTED. STANDARD TOLERANCES TO APPLY UNLESS OTHERWISE SPECIFIED.

CUSTOMER CAN ART STD.	DIE No. EH04047	REV. No. 1
DESCRIPTION 1-1/4 SCHED 10 PIPE	CUSTOMER PART No.	PROPOSAL No. H-35648
	QUOTE No. 17-0608-1	

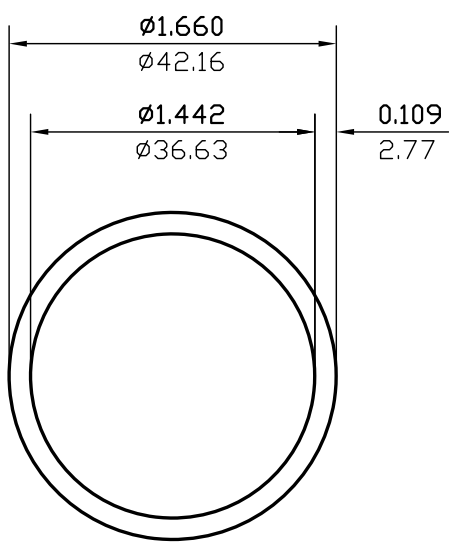

WALL THICKNESS **0.109(2.77)** EXCEPT AS SHOWN

DATE	REV	DESCRIPTION	BY
03/10/23	1	REMOVED ALLOY	JASON
EST.AREA	0.531	IN. ²	EST.AREA
			342.657
			MM. ²
EST.WT.	0.627	LBS/FT.	EST.WT.
			0.933
			KG/M.
EST.PER.	9.745	IN.	EST.PER.
			247.529
			MM.
OUT PER.	5.215	IN.	OUT PER.
			132.5
			MM.
C.C.D.	1.660	IN.	C.C.D.
			42.164
			MM.
FINISH	M/F		ALLOY
CKD BY	FACTOR 16	SCALE 1:1	DWN BY D.L. DATE 06/21/2017

CAN ART

ALUMINUM EXTRUSION L.P.

85 PARKSHORE DRIVE
BRAMPTON, ONT L6T 5M1
TEL. NO. (905) 791-1464
FAX NO. (905) 791-9151
WEB: www.canart.com

THIS DRAWING IS NOT NECESSARILY A COPY OF YOUR ORIGINAL. PLEASE APPROVE DIMENSIONS AND TOLERANCES INDICATED. CAN ART ASSUMES NO RESPONSIBILITY EITHER TECHNICAL OR LEGAL FOR HAVING THIS SHAPE MADE. THE CUSTOMER AGREES TO FULLY PROTECT CAN ART ALUMINUM FROM CLAIMS OF OTHERS RESULTING FROM THIS SHAPE.

SIGNED: _____ DATE: _____